



Penn Medicine

FACTS & FIGURES

2021

Compassion, Commitment, & Change Makers



PENN MEDICINE IS...

*The University of Pennsylvania Health System and
the Raymond and Ruth Perelman School of Medicine*



PATIENT CARE

**Home of the 1st hospital in the
United States, founded in 1751**

Penn Medicine's physicians, nurses, and staff provide exceptional, personalized care to patients with a wide range of medical conditions. Using state-of-the-art equipment and data science, our multidisciplinary clinical teams work together to ensure that patients' needs are addressed from multiple perspectives. Pharmacists, social workers, as well as nutrition and rehabilitation professionals, are all part of the care team along with doctors and nurses.

ON THE FOREFRONT
OF MEDICINE



EDUCATION

1st medical school in the United States

The Perelman School of Medicine — established in 1765 — is consistently ranked among the nation's top academic medical schools by *U.S. News & World Report*. Penn Medicine offers students an innovative, comprehensive curriculum that prepares them to become leading physicians and scientists in the United States and around the world. The community of alumni numbers over 25,160 living and working across the globe.

TRAILBLAZERS
IN EDUCATION



RESEARCH

Recipients of more than \$890M in research funding

Penn Medicine's researchers take an interdisciplinary approach to better understand the fundamental mechanisms of disease, which leads to more precise and personalized treatments. Faculty from dozens of institutes, centers, and departments work in teams spanning the 11 other schools at the University of Pennsylvania, including experts in informatics, bioengineering, and health policy.

LEADERS IN
RESEARCH



COMMUNITY SERVICE

660+ service initiatives funded by CAREs grants

Supporting the community is a cornerstone of Penn Medicine's mission. Every day, physicians, nurses, students, and staff volunteer their time and knowledge to serve people in need. They operate free neighborhood clinics, help low-income residents manage medical appointments and wellness efforts, provide education and mentorship, and conduct other outreach initiatives. Penn Medicine also provides millions of dollars in care for underserved patients each year.

IMPROVING HEALTH
IN OUR COMMUNITY

A GROWING FOOTPRINT

Across the Region

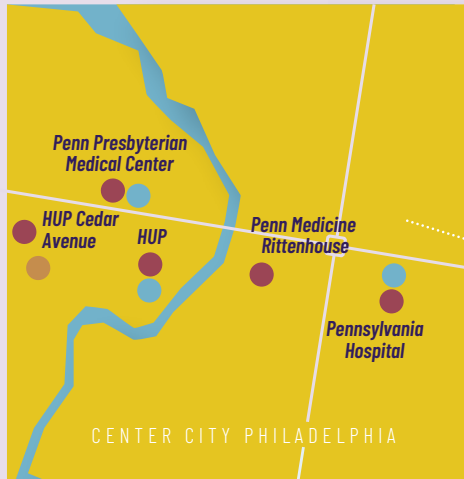

Penn Medicine is powered by a talented and dedicated workforce, all committed to our mission of providing the best care of patients across our region. We also have alliances with top community health systems across Southeastern Pennsylvania and Southern New Jersey, creating more options for patients no matter where they live.

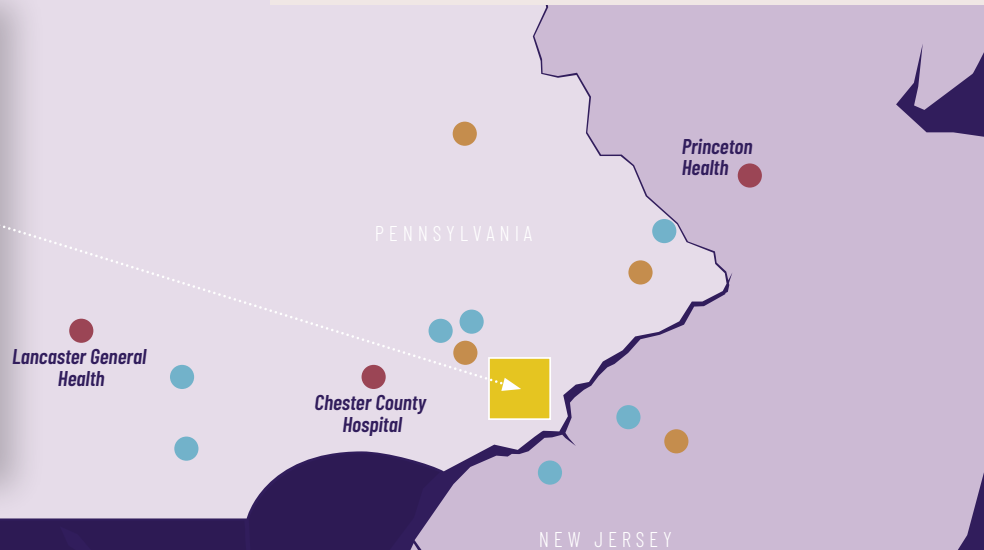

- HOSPITALS
- MULTISPECIALTY OUTPATIENT SITES
- ALLIANCES
 - Virtua Health System
 - Mercy Health System & St. Mary Medical Center
 - Grand View Health

CLINICAL FACILITIES

Outstanding, Personalized Care

Penn Medicine includes six acute-care hospitals and hundreds of outpatient locations throughout the region, as well as educational facilities at the Perelman School of Medicine.



THE HOSPITAL OF THE UNIVERSITY OF PENNSYLVANIA

is Penn Medicine's largest hospital. HUP is a busy inpatient hub for cancer, neurosciences, cardiac care, and many other specialties. It is also the oldest university-owned teaching hospital in the country.

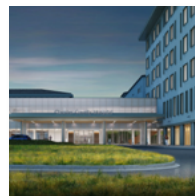

CHESTER COUNTY HOSPITAL

is a hospital complex in West Chester specializing in heart and vascular care, cancer, orthopaedics, and women's health. With satellite locations in Exton, West Goshen, New Garden, Jennersville, Kennett Square, and West Grove, the hospital is the largest in Chester County, with a 250,000-square-foot expansion which opened in 2020.



PENN PRESBYTERIAN MEDICAL CENTER

is a renowned center for cardiac care and ophthalmology. Its campus includes the Musculoskeletal Center's outpatient facility at Penn Medicine University City and the Pavilion for Advanced Care, home to Penn Medicine's first Level 1 Regional Resource Trauma Center.



LANCASTER GENERAL HEALTH

includes the Lancaster General Hospital, the Women & Babies Hospital, and a Level 1 Trauma Center, newly accredited in 2020. It also includes a network of more than 60 outpatient facilities and physician practices in Lancaster, Chester, and Lebanon counties.



PENNSYLVANIA HOSPITAL

is the nation's first hospital, cofounded by Benjamin Franklin in 1751. Today its outstanding clinical programs include the Spine Center, the Center for Transfusion-Free Medicine, maternity and newborn services, and behavioral health. The campus includes Penn Medicine Washington Square, the hospital's outpatient facility.



PENN MEDICINE PRINCETON HEALTH

joined Penn Medicine in 2018 and is among the most comprehensive health care systems in New Jersey, including facilities offering acute-care hospital services, behavioral healthcare, ambulatory surgery, and wellness services.

SPECIALIZED CARE... EVERYWHERE

First-Rate Care Across the Region

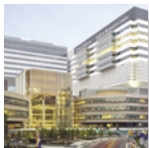

THE PERELMAN CENTER FOR ADVANCED MEDICINE

is a state-of-the-art outpatient facility. PCAM has diagnostic and treatment facilities for cancer, neurological, and cardiac conditions, among other types of specialty care.



PCAM is connected to the Perelman School of Medicine's **JORDAN MEDICAL EDUCATION CENTER** and the **SMILOW CENTER FOR TRANSLATIONAL RESEARCH**, which brings basic scientists and physicians together to spark fresh collaborations and quickly translate discoveries to improve patient care.

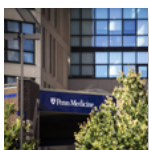

PENN MEDICINE RITTENHOUSE includes a rehabilitation facility, a long-term acute care specialty hospital, and an inpatient hospice.



GOOD SHEPHERD PENN PARTNERS is the post-acute care provider for Penn Medicine. It provides inpatient and outpatient physical rehabilitation and specialized long-term acute care.

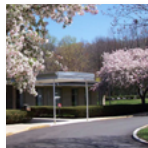

PRINCETON HOUSE BEHAVIORAL HEALTH

and **LANCASTER BEHAVIORAL HEALTH** provide a range of inpatient and outpatient services for patients with mental health, substance abuse, or co-occurring disorders.



PENN MEDICINE AT HOME, which includes Penn Hospice, Penn Home Health, and Penn Home Infusion Therapy, offers a full range of home health needs.



URGENT CARE SOUTH PHILADELPHIA offers fast, convenient care for patients of all ages with minor illnesses and injuries. Patients can walk in seven days a week, including holidays.



MULTISPECIALTY AMBULATORY LOCATIONS

Care Close to Home

Easily accessible care is available throughout the region at Penn Medicine's multispecialty ambulatory locations. These centers offer convenient access to care across many disciplines, as well as laboratory testing and radiology services.

- Bucks County
- Radnor
- Valley Forge
- Cherry Hill
- Southern Chester County
- Washington Square
- Mount Laurel
- University City
- Woodbury Heights

Penn Medicine Radnor's new facility opened in 2020, setting the standard for advanced outpatient care. The four-story state-of-the-art outpatient facility was designed along service lines that group together clinicians by type of condition they treat, such as heart and vascular care, to encourage closer collaboration among specialists and easy access when patients need to see multiple providers in one visit.



40+
medical specialties



250,000
square feet



11
acre campus



250+
trees



NEW FACILITIES

Building for the Future

THE Pavilion

Opening in 2021, the Pavilion rises 17 stories on Penn Medicine's Philadelphia campus as a hospital built to support the future of medicine. The Pavilion includes advanced operating rooms; telemedicine infrastructure for remote monitoring and consultations; and in-room technology to strengthen communication among patients, families, and care teams.



504
private patient rooms



\$1.5
billion facility



47
operating rooms



1 ACRE
of greenery with
landscaping & green roof



INTERVENTIONAL Support Center

The Interventional Support Center (ISC), opened in February 2021, marks a new approach in sterile instrument processing (IP), ensuring the supply of clean and sterilized equipment for surgeries and procedures of all kinds. Located in Southwest Philadelphia, the ISC is designed to process instruments from up to 200 surgical cases each day at HUP and PAH, as well as outpatient facilities.

1ST

such facility in Pennsylvania
& largest in the country

~110,000
square feet

~750
instrument trays processed daily

COMBATING COVID-19

On the Front Lines of a Pandemic

The COVID-19 pandemic reshaped our world and community. In the face of a historic health crisis, faculty and staff demonstrated exceptional courage, compassion, and commitment across every domain of our mission.

Our care teams developed innovative ways to support patients both in our hospitals and via telemedicine platforms; ensured extra layers of safety across hospitals and practices; drove research in search of COVID-19 prevention tactics, treatments, and vaccines; and launched new initiatives to support the health needs of employees and patients.

EXCEPTIONAL COVID-19 Care



310,000+

COVID tests administered for patients & community members



1.78M+

pre-screened for COVID symptoms before in-person visits



6,800+

COVID inpatients cared for



198+

patients seen in the Post-COVID Assessment & Recovery Clinic

IMPACTFUL Giving

Gifts support important work across clinical care, research, & education

1,200+

donors helping to advance work to fight COVID-19

\$14M+

raised for Penn Medicine's COVID-19 response. Of that,

\$9.5M+

raised for research in testing, treatment, & vaccines

SUPPORTING PATIENTS *at Home*



870,000+

telemedicine visits, system-wide



775,000+

COVID Watch texts



400,000+

Penn Medicine COVID Hotline calls



200,000+

Penn Home Infusion Therapy treatments

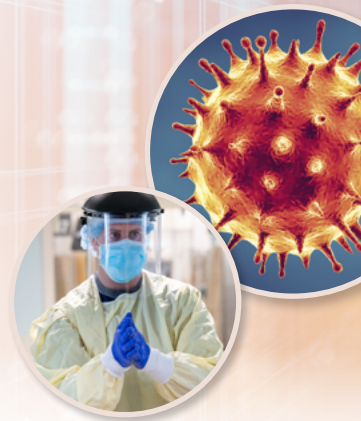

COVID 19 Research



4

vaccine clinical trials conducted



30+

clinical trials launched

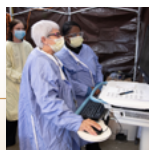

150+

non-clinical trials research



100+

labs pivoted to COVID-19 research in March 2020



1,548

COVID-19 patient samples added to Penn's biobank

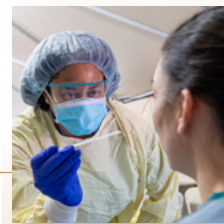

3,722

subjects enrolled in COVID-19 studies

PATIENT CARE

On the Forefront of Medicine



HELEN O. DICKENS Center for Women

Comprehensive gynecological and obstetrical care and education to underserved women within the Philadelphia community

 23,700+ appointments in FY20

 4,160+ new patients

 1,445 Dickens Center patient babies delivered at HUP

 Founded in 1967

PENN Spine Center

Providing seamless, integrated spine care across the network

 31,000+ spine & back injections in FY20

 10,350+ appointments at the new Spine Center at PAH

 75+ physicians & advanced practice providers

 25+ ambulatory locations

From emergency departments to inpatient units to outpatient clinics across the region, our physicians, nurses, pharmacists, social workers, and other members of the care team put patients first in every setting. We're leveraging telemedicine, mobile apps, and remote monitoring technologies to provide options that offer patients more convenience and enhance their safety — both when they're in our facilities and at home.

Penn Medicine's **Abramson Cancer Center**, designated as a Comprehensive Cancer Center by the National Cancer Institute since 1973, is a world leader in cancer research, patient care, and education. At the **Roberts Proton Therapy Center**, the largest integrated radiation oncology center in the world, patients are treated with this highly precise form of radiation, which eradicates tumors while sparing healthy surrounding tissue and eliminating many side effects of conventional radiation treatment. Many Penn physicians also see patients at Children's Hospital of Philadelphia and the Corporal Michael J. Crescenz VA Medical Center.

IMPROVING MENTAL HEALTH *with Primary Care*

Penn Integrated Care embeds mental health providers in primary care practices, supported by psychiatrists and a resource center



11,900+ patients since the launch of the program in 2019



1,780+ suicidal patients were identified and received care

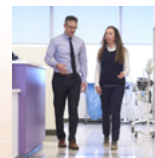

42% experienced significant improvement in depression & anxiety symptoms

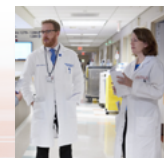

12 PIC primary care practices, with more to come

RESEARCH

Tomorrow's Cures, Today



PENN MEDICINE *Biobank*

Samples donated by volunteers to support new & emerging medical research and drive the next generation of treatments and cures. *Data as of December 2020

 **90,420**
blood encounters banked

 **45,374**
participants with genomic data

 **293,848**
tissue specimens from

 **50.3%**
female &

 **73,000+**
subjects

 **49.7%**
male subjects

COLLABORATIVE RESEARCH *by the Numbers*



6,800+
faculty & staff



4,100+
students, post doctoral
trainees, & fellows



48
departmental centers



28
basic & clinical
departments



26
free-standing
institutes

Penn Medicine is an internationally recognized leader for discoveries that advance science and patient care. Eighty-three Penn Medicine researchers are members of the National Academy of Medicine, one of the highest honors in medicine.

From fundamental and discovery science to clinical research, Penn Medicine's laboratories and hospitals improve care for a wide range of medical conditions and provide the foundation for the next generation of therapies. The culture and campus of the University of Pennsylvania encourages close collaboration between scientists and clinicians, exemplified by its dozens of interdisciplinary clinical and research institutes, centers, and programs.

IMMUNE HEALTH & Cell Therapy Pioneers

Harnessing patients' own immune systems to pioneer treatment and fight disease

 **220+**
Institute for Immunology
faculty members: largest in
the world

 **\$24M**
in funding for cancer
immunobiology research
in 2020

 **~200**
cancer patients enrolled
in cell therapy trials



A NEW PATH *to Parenthood*

Uterus Transplant for Uterine Factor Infertility (UNTIL) trial

 **1ST**
uterus transplant clinical trial
to launch in the northeast

 **3**
transplants completed –
2 deceased donors, 1 living donor

 **2**
babies born as part of the trial

 **WATCH THE VIDEO:**
[penmedicine.org/UNTIL](https://www.pennmedicine.org/UNTIL)

EDUCATION

Trailblazers in Medical Education



The Perelman School of Medicine has an international reputation for innovative training programs in areas ranging from leadership to global health. Its groundbreaking curriculum has set a new standard for medical education nationwide and is a model for other academic medical schools. The curriculum is built on a foundation of evidence-based medicine and patient-centered care, integrating basic sciences and clinical experience and fostering interdisciplinary teamwork.

GRADUATE MEDICAL Education



83

ACGME-accredited residency and fellowship programs



57

non-ACGME fellowships sponsored by departments



1,085

residents at HUP, PPMC, LGH, & PAH



390

fellows at HUP, PPMC, & PAH

PERELMAN SCHOOL OF MEDICINE Enrollment

778

medical students

217

enrolled in MD/PhD programs across Penn

INCOMING CLASS OF 2020/2021



155 students



48% female



36

pursuing an MD/PhD



65% non-traditional applicants



52% male

GRADUATING CLASS OF 2020



155 graduates



47

graduates training at Penn, CHOP, or the Scheie Eye Institute



53

earned certificates & advanced degrees

Top Specialties



Internal Medicine



Ophthalmology



Dermatology

GLOBAL ENGAGEMENT

Improving Health Around the World

The **Center for Global Health** launched in 2015 to synthesize and expand Penn Medicine's efforts to improve worldwide health equity. The center's vision for the future is to build a healthier world by training tomorrow's leaders, addressing global health disparities, supporting regional centers of engagement in underserved locations, and uniting the Penn global health community through workshops, pilot projects, and seminars.

Despite disruptions in global travel imposed by the COVID-19 pandemic in 2020, the Center for Global Health continued to provide engaging opportunities for a wide array of constituents across Penn's campus.

CENTER FOR GLOBAL HEALTH FY20



163

Global Health activities in 58 countries



61

PSOM students completed training opportunities in the classroom & the field



772

participants in Global Health events



14

international students involved in Global Health activities at Penn & via remote research

INCLUSION & DIVERSITY

Embracing Diversity, Broadening Access

Penn Medicine is taking action to address all forms of racism and bias within the community. Penn is dedicated to changing the culture and breaking down barriers for not only employees but the patients Penn serves and the community at large.

In July 2020, Penn Medicine launched the **Action for Cultural Transformation (ACT)**, which aims to ensure equity, mitigate bias, and eliminate structural racism at Penn Medicine. The ACT agenda includes widening opportunities for advancement of underrepresented minorities within our school and workforce and addressing the social determinants of health that affect minority patients' lives. Among the array of efforts underway, we have committed to providing unconscious bias training for our entire workforce by April 1, 2021.

13,196

completed Unconscious Bias Training from July-December 2020

42.8%

PSOM full-time women faculty and 71% underrepresented minority faculty in 2020

14

new vice-chairs of Inclusion, Diversity, & Equity appointed in 2020

LGBTQ

All 6 hospitals earned recognition as 2020 "LGBTQ Healthcare Equality Leaders" by the Human Rights Campaign Foundation

7

Office of Inclusion and Diversity anchor programs, including the Alliance of Minority Physicians



COMMUNITY SERVICE

Making a Meaningful Impact

Our commitment to care for people in Pennsylvania and New Jersey extends far beyond the walls of our facilities. Every day, physicians, nurses, medical students, researchers, and staff lend their time, skills, and knowledge to help the communities the health system serves, often as volunteers outside of their work.

Penn Medicine's CAREs grant program supports faculty, students, and staff who volunteer in community-based programs from metropolitan Philadelphia to rural Lancaster and Chester counties to the suburbs and shore communities of New Jersey. Since CAREs was established in 2011, it has provided grants to over 660 service initiatives, including programs in community centers, farmers markets, and places of worship.



GIVING BACK IN FY20



\$300.7M
in charity and underfunded care for Medicaid families



\$147.9M
in research support and community health improvement services



\$114.6M
in physician training support



+\$1.5M
raised by Penn's Way campaign

SERVICE IN Action

Improving health in a meaningful way is at the heart of what drives Penn Medicine. This calling inspires the passion and creativity of an extraordinarily talented and dedicated team of physicians, nurses, faculty, trainees, students, staff, and volunteers. You can see inspiring stories of service in action in the Penn Medicine community impact report at communityimpact.pennmedicine.org.



\$100M
contributed by Penn to the School District of Philadelphia—\$10 million annually for 10 years. The contribution will benefit generations of Philadelphia students, their teachers, and school staff.

IN THE NEIGHBORHOOD

Improving the Well-Being of Our Communities



The **Penn Medicine Votes Project** helped 4,150 patients and employees register to vote or sign up for a mail ballot. During election week, the group helped over 225 additional patients vote using an emergency absentee ballot.



In an effort to promote healthy eating, Chester County Hospital welcomed the **FreshtoYou** truck from the Chester County Food bank on its campus during the fall.



Lancaster General Health leads the community coalition **Joining Forces for Children** which supports child victims of the opioid crisis by providing a Family Advocate to help navigate access to services.

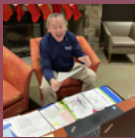

In 2020, Princeton Health launched **Mental Health First Aid**—a training which gives participants tools to identify individuals who are experiencing mental health or substance use issues and guide them to appropriate professional help.



The all-female **Penn Academy for Reproductive Sciences** teaches high school students interested in exploring the world of medicine, particularly reproductive science.

ECONOMIC DEVELOPMENT

An Engine for Progress

Penn Medicine is the top health care employer in the city of Philadelphia



\$15.1B

in total economic impact

IMPROVING THE REGION'S
Economic Health

\$208.6M

total annual tax revenue

ECONOMIC IMPACT BY *State and City*

\$13.7B

total impact in Pennsylvania

\$9.3B

total impact in Philadelphia

\$1.4B

total impact in New Jersey

70,790

jobs supported in Pennsylvania

40,490

jobs supported in Philadelphia

9,200

jobs supported in New Jersey

AWARDS & ACCOLADES

Leading with Distinction



U.S. NEWS & *World Report*

Penn Medicine hospitals were ranked among the top hospitals in the nation by *U.S. News & World Report* in 2020. HUP-PPMC was named to the magazine's prestigious "Honor Roll" list for the 14th consecutive year, and 12 clinical specialties received top rankings.

Penn Medicine's hospitals are all recognized as among the best regionally:



#1

HUP-PPMC in Pennsylvania & the Philadelphia metro area



#5

Chester County Hospital in the Philadelphia region



#4

Lancaster General Health in Pennsylvania



#9

Princeton Health in New Jersey



#4

Pennsylvania Hospital in the Philadelphia region

A LEADING *Employer*

#22

on *Forbes* magazine's annual "Best Employers for Diversity 2020" list

HEALTHIEST EMPLOYER

Named one of *Philadelphia Business Journals* 2020 Healthiest Employers

NATIONAL & REGIONAL *Recognition*



#3

research-oriented medical school by *U.S. News & World Report* in 2020



482

physicians included in *Philadelphia* magazine's "Top Docs" 2020 list



All acute care facilities achieved **Magnet status** from the American Nurses Credentialing Center

REGIONAL ENTITY *Recognition*

1 OF 4

Princeton Health is 1 of 4 health care organizations in NJ to hold advanced certification in total hip and total knee replacement from The Joint Commission

5 STARS

Chester County Hospital and Lancaster General Health have been awarded five-star ratings by CMS

PENN MEDICINE FISCAL YEAR 2020

Profile for FY20

ANNUAL OPERATING *Revenue*



\$8.9 BILLION



Research & Education

Total Sponsored Research	\$891.1 Million
NIH Awards	\$496 Million
PA State Research Funding	\$4.8 Million
Licensing Revenue	\$31.1 Million
New Patents Awarded	84
Full-Time Faculty (includes CHOP)	2,810
MD Students	778
PhD Students	753
VMD-PhD Students	19
MD/PhD Students	217
Residents & Fellows (HUP, PPMC, PAH, LGH)	1,475
Postdoctoral Fellows	890



Philanthropy

Gifts	\$242 Million
Donors	25,244
Alumni Giving Participation	24%

	TOTAL	HUP	PAH	PPMC	CCH	LGH	PMPH	PSOM
Outpatient Visits¹	5,684,554	1,830,448	255,680	240,254	420,188	1,156,129	211,014	
ED Visits	337,712	59,016	39,112	46,395	37,043	111,931	44,215	
Adult Admissions	129,016	33,473	17,923	17,244	14,132	29,245	16,999	
Births	19,272	4,381	5,357	—	2,967	4,312	2,255	
Licensed Beds²	2,941	807	475	375	252	603	429	
Physicians³	8,923	2,488	1,632	1,746	703	909	1,445	
Employees⁴	44,254	6,862	2,885	2,738	2,516	10,961	2,970	6,825 ⁵

KEY TO ABBREVIATIONS:

CCA: Clinical Care Associates	HCHS: Home Care & Hospice Services
CCH: Chester County Hospital	HUP: Hospital of the University of Pennsylvania
CHCA: Clinical Health Care Associates	LGH: Lancaster General Health
CHOP: The Children's Hospital of Philadelphia	PMPH: Penn Medicine Princeton Health
CPUP: Clinical Practices of the University of Pennsylvania	PPMC: Penn Presbyterian Medical Center
ED: Emergency Department	PAH: Pennsylvania Hospital
GSPP: Good Shepherd Penn Partners	PSOM: Perelman School of Medicine

KEY TO SUPERSCRIPTS:

- (1) Includes CCA/CHCA, GSPP, HCHS
- (2) Includes newborn bassinets
- (3) Includes physicians with privileges at >1 hospital
- (4) Includes CCA, CORP, CPUP, HCHS
- (5) Includes staff and full-time faculty